

RS700

Converting pre 2019 boats to non
raking daggerboard and fitting aero
daggerboard



PLEASE FOLLOW INSTRUCTIONS IN CORRECT ORDER

RS700

Raking case to vertical case modification

Materials needed:

1 piece of 18mm marine plywood (recommended)
Other materials can be used if required such as kitchen chopping board

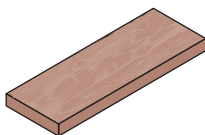

Tools required:

- Sikaflex
- Scissors
- Sand paper
- Epoxy
- Jigsaw/Coping saw
- Metal ruler

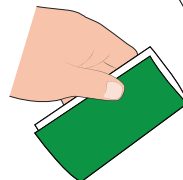
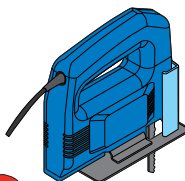
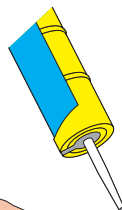
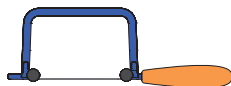

RS 700

RS 700 Vertical case modification

1)

Print off the template and carefully cut it out.

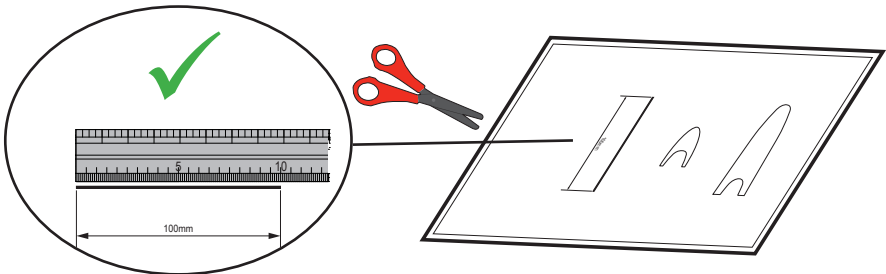

Measure the 100mm bar to ensure the outlines are printed to the right size.

2)

Place the templates on a piece of 5-18mm material. We recommend marine plywood. To cut out the shapes either use a jigsaw or a coping saw.

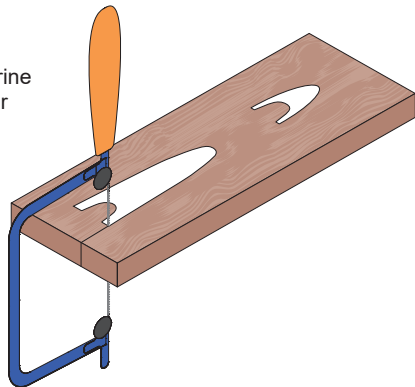

3)

Push the chocks into the case ensuring they fit flush to the surface.

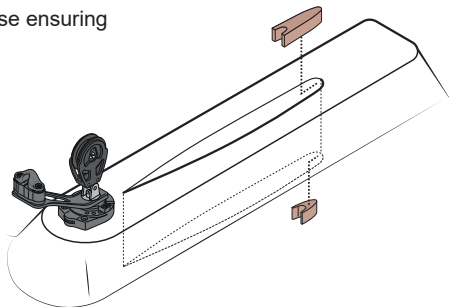

Make sure the chocks fit properly and you can put the daggerboard in with ease before continuing.

RS 700 Vertical case modification

- 4) Use either sikaflex or epoxy to stick the chocks into palce.

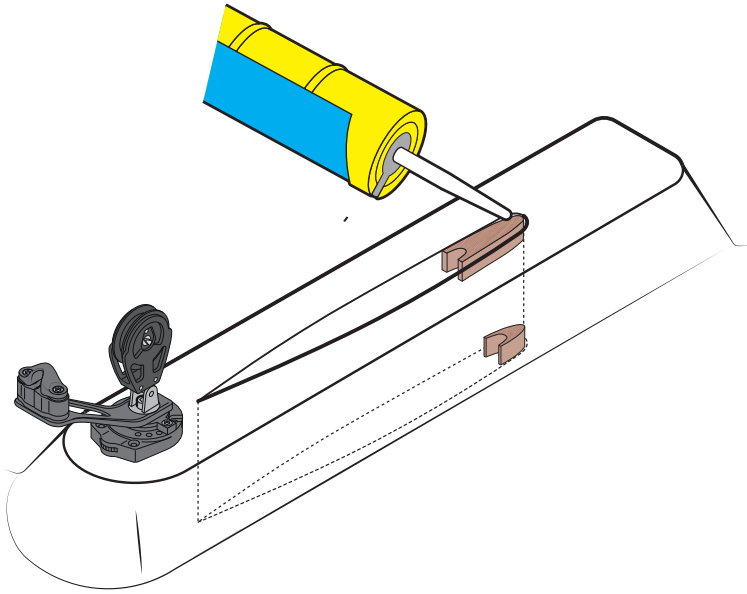

Aero board case modification

Materials needed:

1 piece of wood. this will be used for outlining where to sand to on your case so does not need to be marine grade.

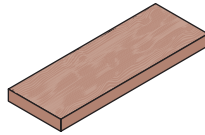

Tools required:

- Scissors
- Sand paper
- Pen
- Jigsaw/Coping saw
- Metal ruler

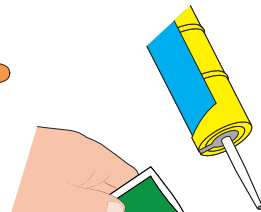
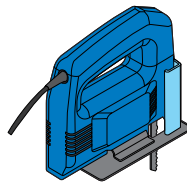
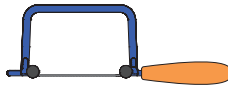

RS 700

RS 700 Aero board case modification

1)

Print off the template and carefully cut it out.

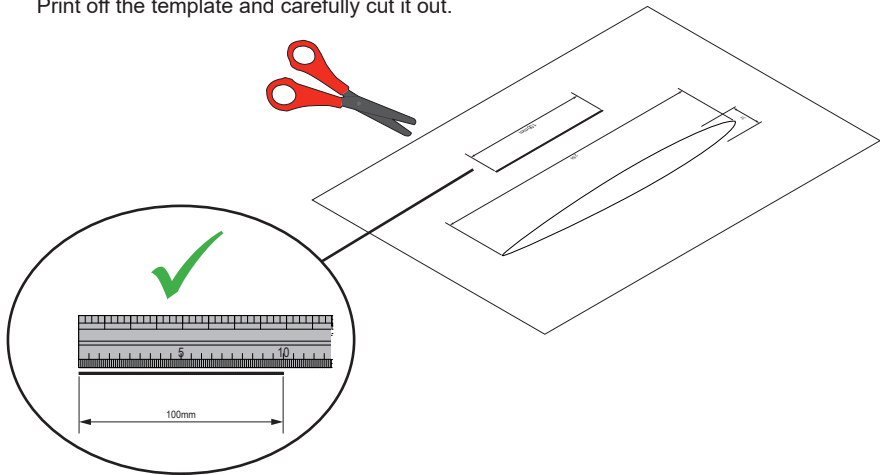

When cutting out the templates take care to be as precise as possible in order to save time sanding the case further later.

2)

Place the templates on a piece of appropriate material. To cut out the shapes either use a jigsaw or a coping saw.

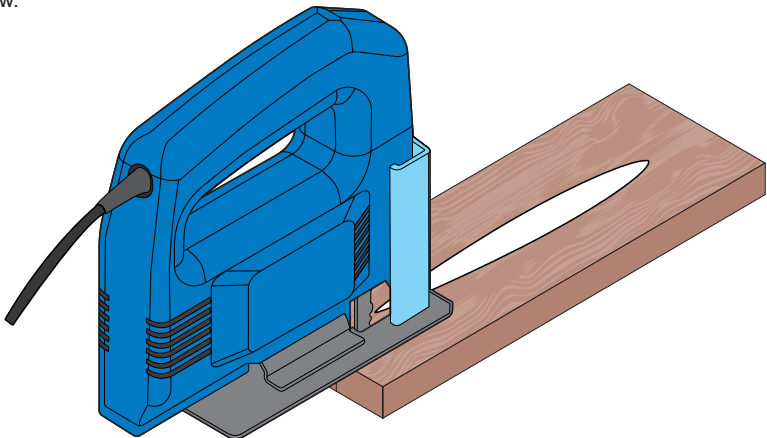

RS 700 Aero board case modification

4)

Place the template on top of the daggerboard case and mark with a pen/pencil the line which you will sand the case out to.

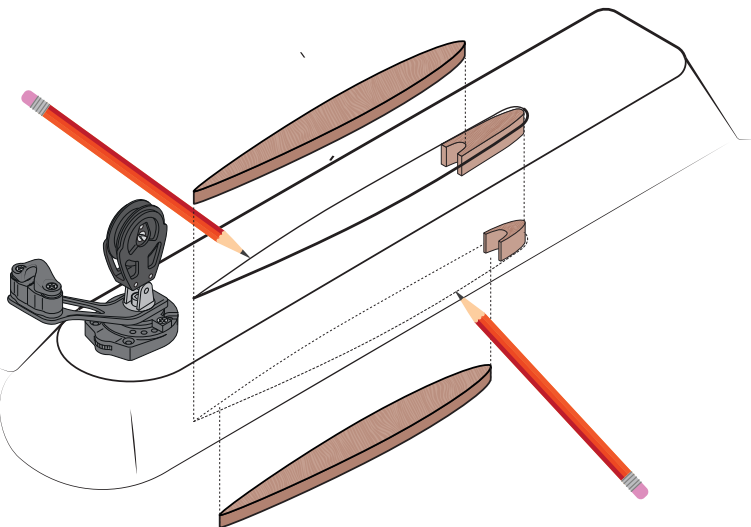

5)

Carefully sand the case out to the line drawn. Try inserting the daggerboard and sand further if necessary.

